

PLAN VIEW



FLOOD PLAIN MANAGEMENT

A PORTION OF THE WORK AREA LIES WITHIN THE TRADING COVE BROOK 100-YEAR FLOOD PLAIN AND FLOODWAY.

1. THERE SHALL BE NO BUOYANT, HAZARDOUS FLAMMABLE, EXPLOSIVE, SOLUBLE, EXPANSIVE, OR ANY OTHER MATERIAL WHICH COULD BE INJURIOUS TO HUMAN, ANIMAL OR PLANT LIFE STORED WITHIN THIS AREA AT ANY TIME.
2. NO STORAGE OF CONSTRUCTION EQUIPMENT AND/OR MATERIAL SHALL OCCUR WITHIN THE FLOOD PLAIN UNLESS SUCH EQUIPMENT OR MATERIAL IS NOT SUBJECT TO MAJOR FLOOD DAMAGE, IS ANCHORED, RESTRAINED OR ENCLOSED TO PREVENT IT FROM FLOATING AWAY OR IS REMOVED PRIOR TO FLOODING.
3. THE CONTRACTOR SHALL MONITOR WEATHER CONDITIONS AND RIVER ELEVATIONS. IN THE EVENT OF A PREDICTED MAJOR STORM, POTENTIAL FLOODING OR AT THE DIRECTION OF THE OWNER OR ENGINEER, THE CONTRACTOR MUST REMOVE EQUIPMENT AND LOOSE MATERIALS FROM THE FLOOD PLAIN AND SECURE THE SITE.
4. THE CONTRACTOR SHALL MAKE PROVISIONS FOR AND SHALL BE SOLELY RESPONSIBLE FOR SECURING THE WORK IN PROGRESS AND ANY MATERIAL STOCKPILES PRIOR TO A MAJOR STORM.
5. THE CONTRACTOR SHALL SUBMIT A WRITTEN FLOOD CONTINGENCY PLAN TO THE ENGINEER PRIOR TO THE START OF CONSTRUCTION.

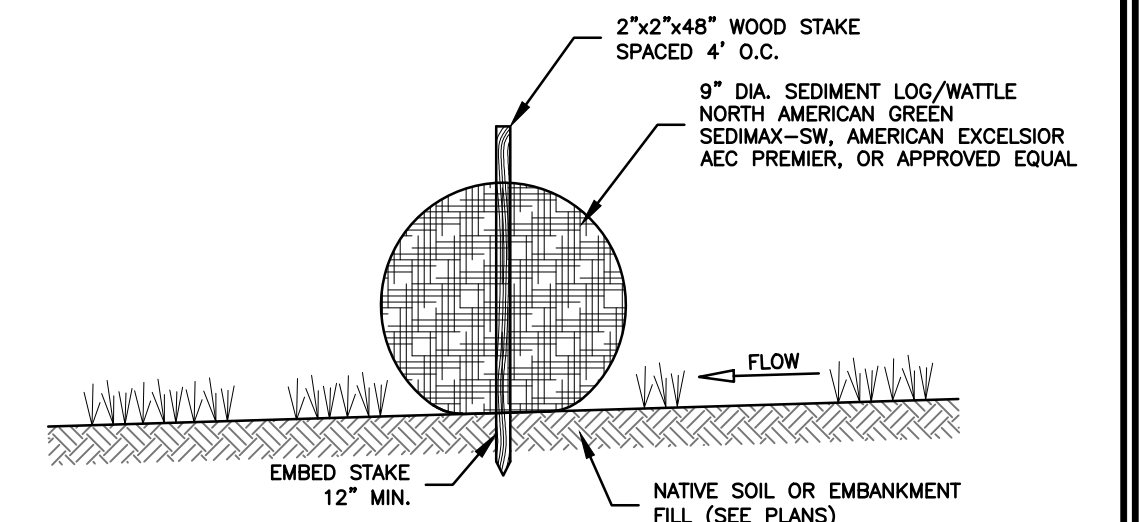

NOTES:
1. STORMWATER LOG ENDS SHALL BE TIED TOGETHER, OVERLAPPED AT LEAST 24\"/>

STORMWATER SEDIMENT LOG (WATTLE) DETAIL
NOT TO SCALE

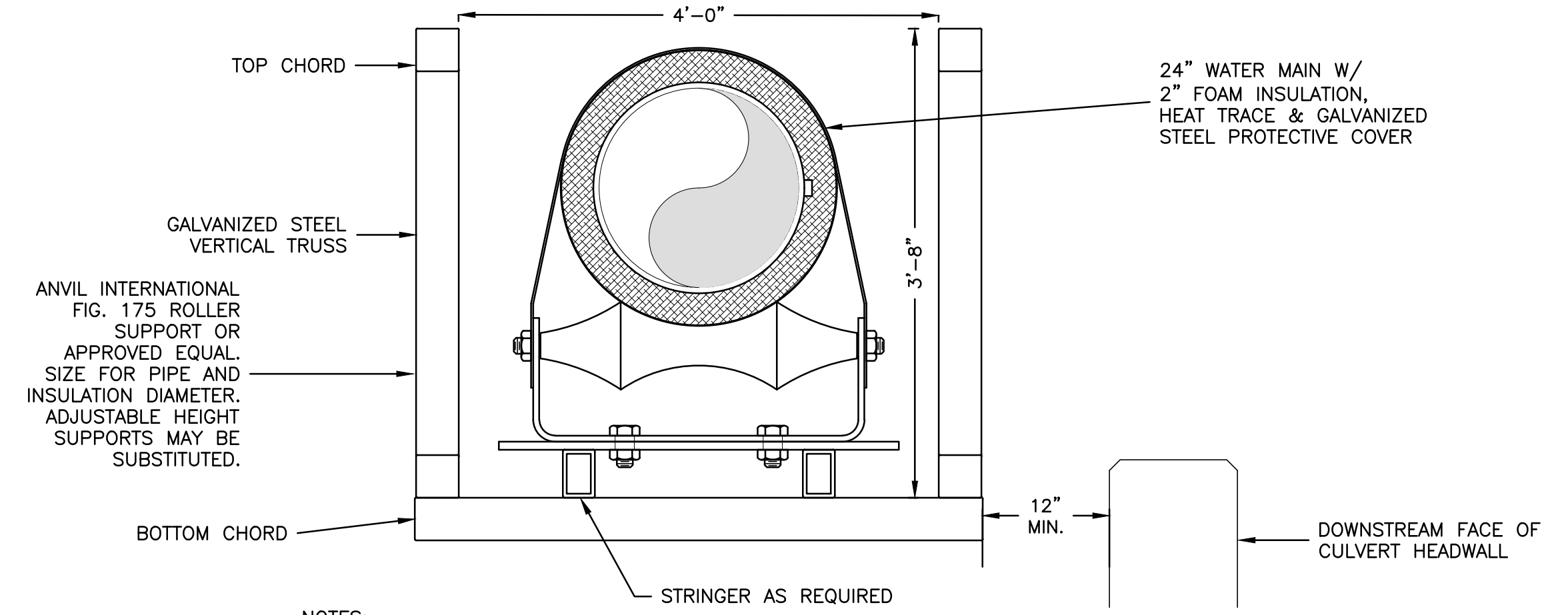

- NOTES:
1. UTILITY BRIDGE TO BE MANUFACTURED BY CONSPAN ENGINEERED SOLUTIONS OR APPROVED EQUAL.
 2. DIMENSIONS ABOVE ARE APPROXIMATE AND SHALL BE ADJUSTED BY THE MANUFACTURER TO MEET THE DESIGN REQUIREMENTS.
 3. ALL METAL ELEMENTS SHALL BE GALVANIZED.

UTILITY BRIDGE SECTION DETAIL

NOT TO SCALE

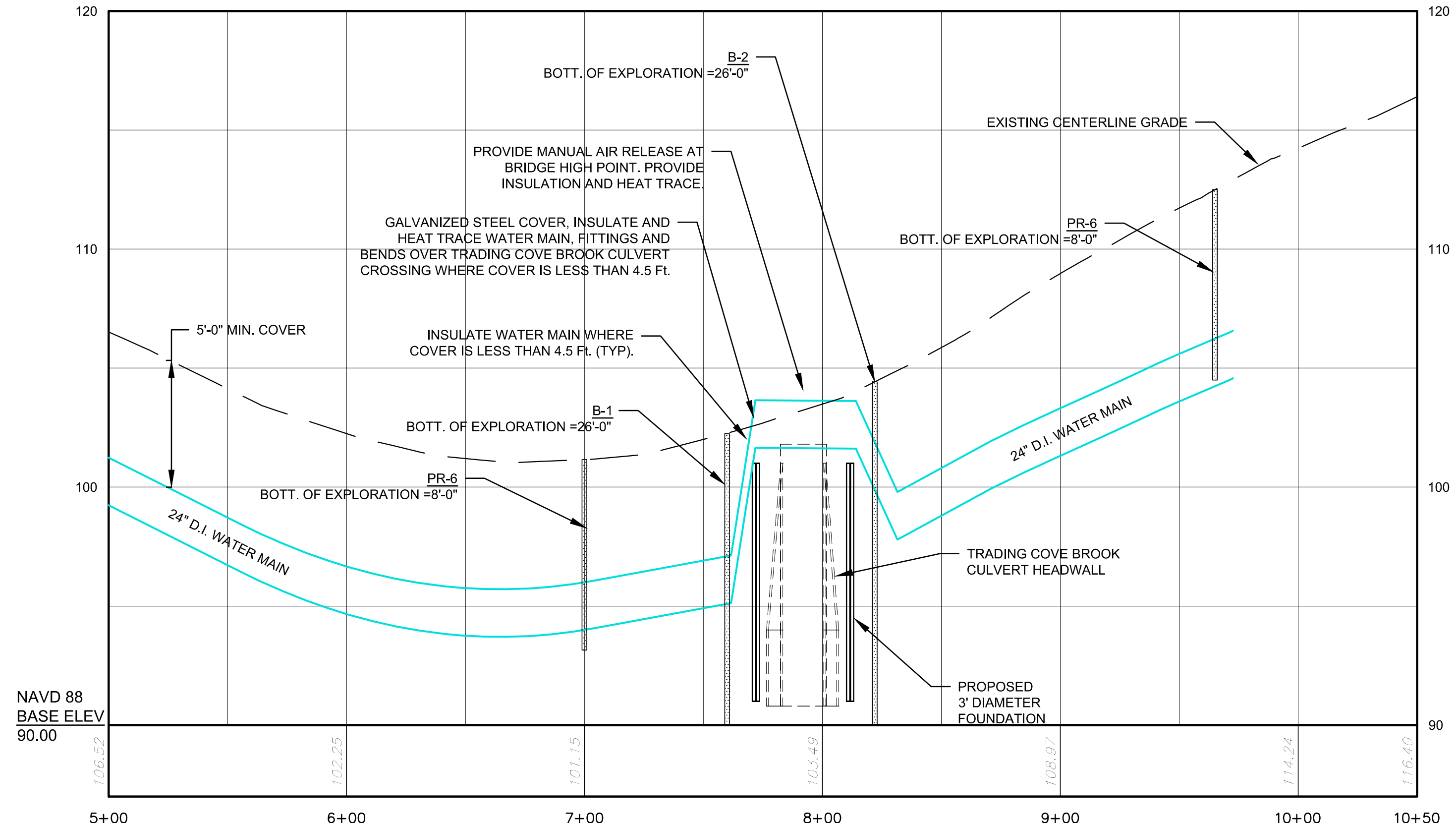

PROFILE VIEW - NOBLE HILL ROAD

Sta. 5+00 to Sta. 10+50
Horiz. Scale: 1" = 40'
Vert. Scale: 1" = 4'

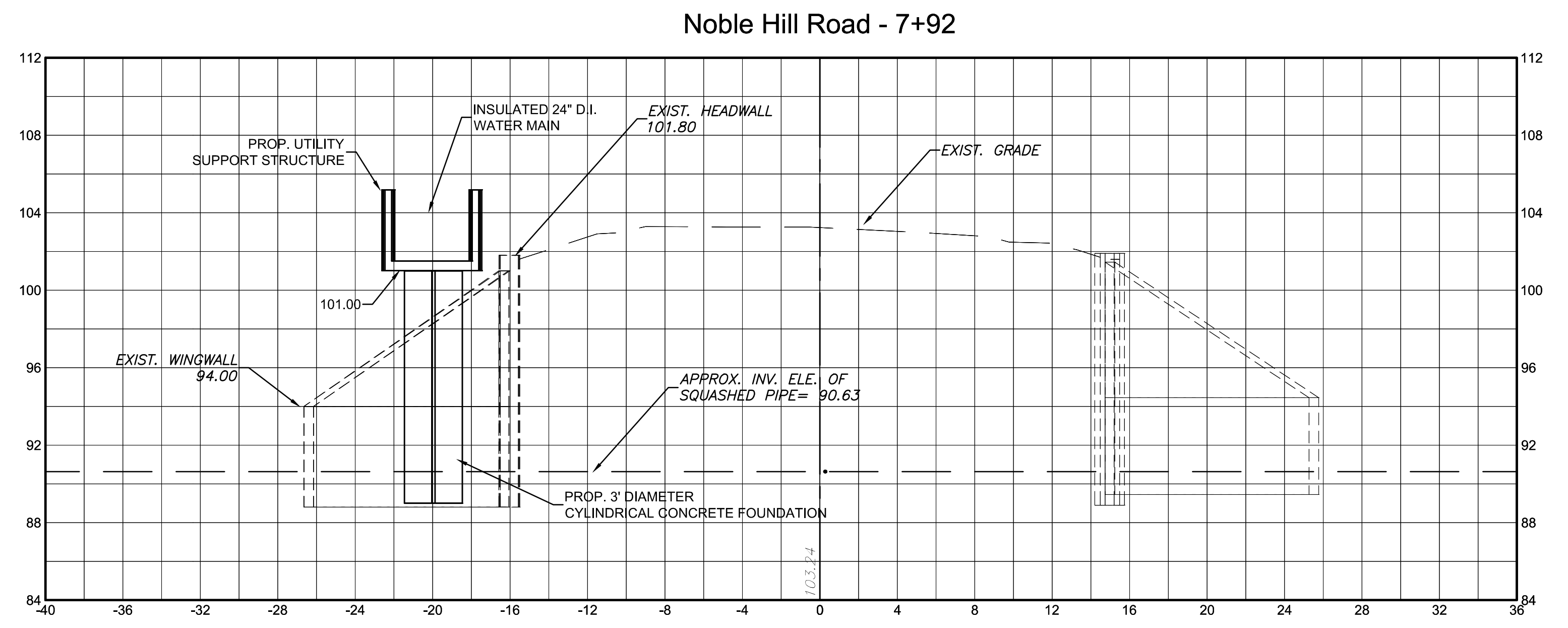

SECTION VIEW

SCALE: 1" = 5'

I HAVE REVIEWED THE WETLANDS ON THE PROPERTY IN THE FIELD AND HAVE REVIEWED THE WETLANDS AS SHOWN ON THE PLAN AND FIND THAT THEY SUBSTANTIALLY REPRESENT THE WETLANDS AS DELINEATED IN THE FIELD.

ROBERT C. RUSSO
CERTIFIED SOIL SCIENTIST

EROSION & SEDIMENT CONTROL PLAN CERTIFIED BY VOTE OF THE BOZRAH INLAND WETLANDS COMMISSION ON _____

CHAIRMAN OR SECRETARY OF THE COMMISSION

<p>CLA Engineers, Inc. CIVIL • STRUCTURAL • SURVEYING</p> <p>317 Main Street Norwich, CT 06360 (860) 886-1966 Fax (860) 886-9165</p>			Project No. CLA-6073
			Proj. Engineer D.P.H.
<p>NORWICH PUBLIC UTILITIES</p>			Date: 08/07/18
<p>STONY BROOK TRANSMISSION MAIN REHABILITATION - PHASE 1</p>			Sheet No. 1
<p>EROSION & SEDIMENT CONTROL PLAN AT TRADING COVE BROOK</p>			